

BRC4 Remote Control

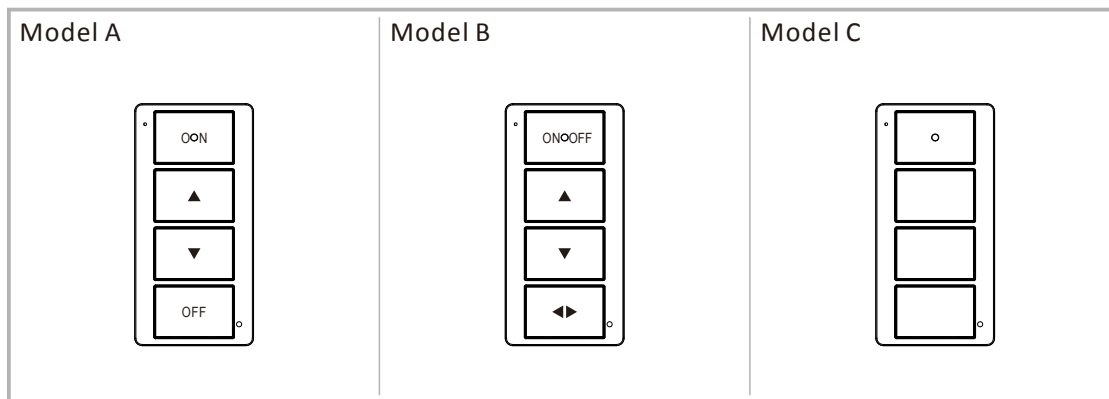
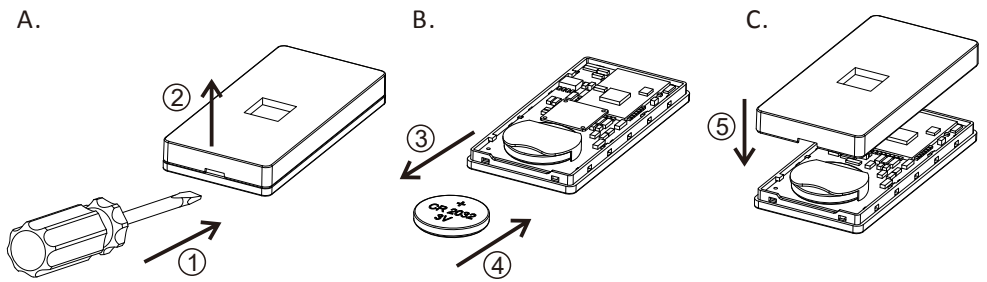
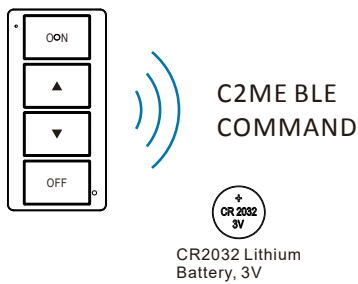
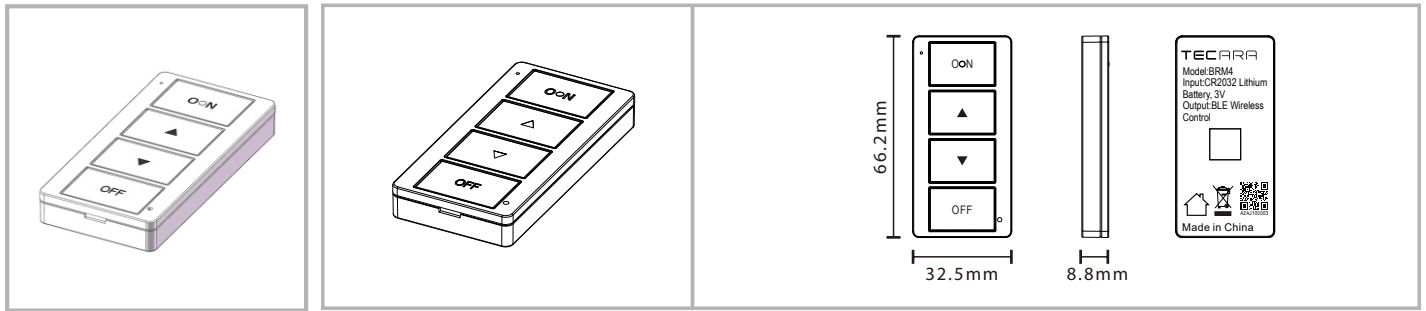

Remark:

This remote control uses lithium battery and can provide BLE wireless ON/OFF and dimming control through the 4 buttons on its faceplate. Ranged 30 meters line of sight.

Technical Specs:

Input: CR2032 Lithium Battery, 3V
 Number of buttons: 4
 Output: BLE wireless control

Applications:

Install smooth surface
 US single gang fit wall switch

Ordering Codes

Follow the steps to specify your fixture.

example:

| ① Base Code | ② Code | Model |
|-------------|--------|---------|
| BRC4 | 01 | Model A |
| | 02 | Model B |
| | 03 | Model C |

